

LEGEND

	DENOTES EXISTING UTILITY POLE
	DENOTES EXISTING OVERHEAD WIRES
	DENOTES EXISTING STONE LINED DITCH
	DENOTES EXISTING WATER VALVE
	DENOTES EXISTING ACCESS LID
	DENOTES EXISTING CONTOUR LINE

- REFERENCES:**
- VILLAGE OF SOUTH BLOOMING GROVE TAX MAP SECTION 210.
 - DEEDS FILED IN THE ORANGE COUNTY CLERK'S OFFICE AS:
L.14409 P.1024 L.15041 P.1780 L.14208 P.760
L.14829 P.1671 L.15167 P.1524
L.14171 P.733 L.14374 P.1968
 - MAP FILED IN THE ORANGE COUNTY CLERK'S OFFICE AS:
FILED MAP #2852
FILED MAP #7627
FILED MAP #6583

REVISIONS:
2/28/24--SET PROPERTY CORNERS
UPDATED TOPOGRAPHIC FEATURES

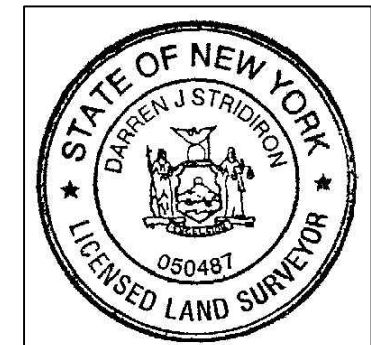

I HEREBY CERTIFY THAT:
THIS MAP OR PLAT IS BASED UPON THE FIELD NOTES OF THE SURVEY AND OTHER REFERENCES SHOWN.
ALL RECORDED EASEMENTS OR RIGHTS-OF-WAY AS SHOWN IN THE TITLE REPORT AND OTHER REFERENCES ARE SHOWN.
ALL OBSERVABLE EVIDENCE OF EASEMENTS ON THE GROUND ARE SHOWN.
ALL OBSERVABLE, ABOVE GROUND EVIDENCE OF BUILDINGS, STRUCTURES AND OTHER IMPROVEMENTS ARE SHOWN.

UNAUTHORIZED ALTERATION TO A MAP BEARING A LICENSED PROFESSIONAL LAND SURVEYOR'S SEAL IS A VIOLATION OF SECTION 7209, SUBDIVISION 2, OF THE NEW YORK STATE EDUCATION LAW.
THIS CERTIFICATION IS NOT AN EXPRESS OR IMPLIED WARRANTY OR GUARANTEE, IT IS PURELY A STATEMENT OF PROFESSIONAL OPINION BASED ON KNOWLEDGE, INFORMATION AND BELIEF, BASED ON EXISTING FIELD EVIDENCE AND DOCUMENTARY EVIDENCE AVAILABLE.
CERTIFICATIONS ARE NOT TRANSFERABLE TO ADDITIONAL INSTITUTIONS OR SUBSEQUENT OWNERS.
PLAN PREPARED PURSUANT TO SECTION 7208m OF THE NEW YORK STATE EDUCATION LAW.
SUBJECT TO THE FINDINGS OF AN UP-TO-DATE TITLE SEARCH.

Darren Stridiron
DARREN J. STRIDIRON, P.L.S.
NEW YORK STATE LICENSE No. 050487

**BOUNDARY & TOPOGRAPHIC SURVEY
LOCATED AT**

47 MANGIN ROAD

VILLAGE OF SOUTH BLOOMING GROVE
ORANGE COUNTY NEW YORK

CV ASSOCIATES NY, P.E., L.S., P.C.
148 ROUTE 17M SUITE 2, HARRIMAN, NY 10926

TAX LOT:
210-4-3

AREA: AS SHOWN

DATE: 1/29/24

SCALE: 1" = 30'

JOB NO. 1460-80