

Certifications on this boundary survey map signify that the map was prepared in accordance with the current existing Code of Practice for Land Surveys adopted by the New York State Association of Professional Land Surveyors, Inc. The certification is limited to persons for whom the boundary survey map is prepared, to the title company, to the governmental agency, and to the lending institution listed on this boundary survey map.

Any alteration or addition to this survey is a violation of SECTION 7209 of the NEW YORK STATE EDUCATION LAW, except as per SUBDIVISION 2. All certifications hereon are valid for this map and copies thereof only if said map or copies bear the inked or impressed seal of the surveyor whose signature appears hereon.

SURVEYED WITHOUT THE BENEFIT OF A TITLE SEARCH
 EASEMENTS AND/OR SUBSURFACE STRUCTURES RECORDED OR UNRECORDED ARE NOT GUARANTEED UNLESS PHYSICALLY EVIDENT ON THE PREMISES AT THE TIME OF THE SURVEY
 SUBJECT TO COVENANTS, EASEMENTS, RESTRICTIONS, CONDITIONS AND AGREEMENTS OF RECORD
 UNDERGROUND UTILITIES SHOWN HEREON BASED ON UTILITY EVIDENCE VISIBLE AT GROUND SURFACE AND ARE SUBJECT TO FIELD VERIFICATION BY EXCAVATION
 UTILITIES SHOWN DO NOT PURPORT TO CONSTITUTE OR REPRESENT ALL UTILITIES LOCATED UPON OR ADJACENT TO THE SURVEYED PREMISES
 WETLANDS IF ANY ARE NOT SHOWN
 PREMISES SURVEYED KNOWN AS BEING LOT NUMBER 2 ON A CERTAIN MAP ENTITLED "SUBDIVISION FOR WILLIAM HALDENWANG" FILED IN THE ORANGE COUNTY CLERK'S OFFICE AS MAP NUMBER 9548

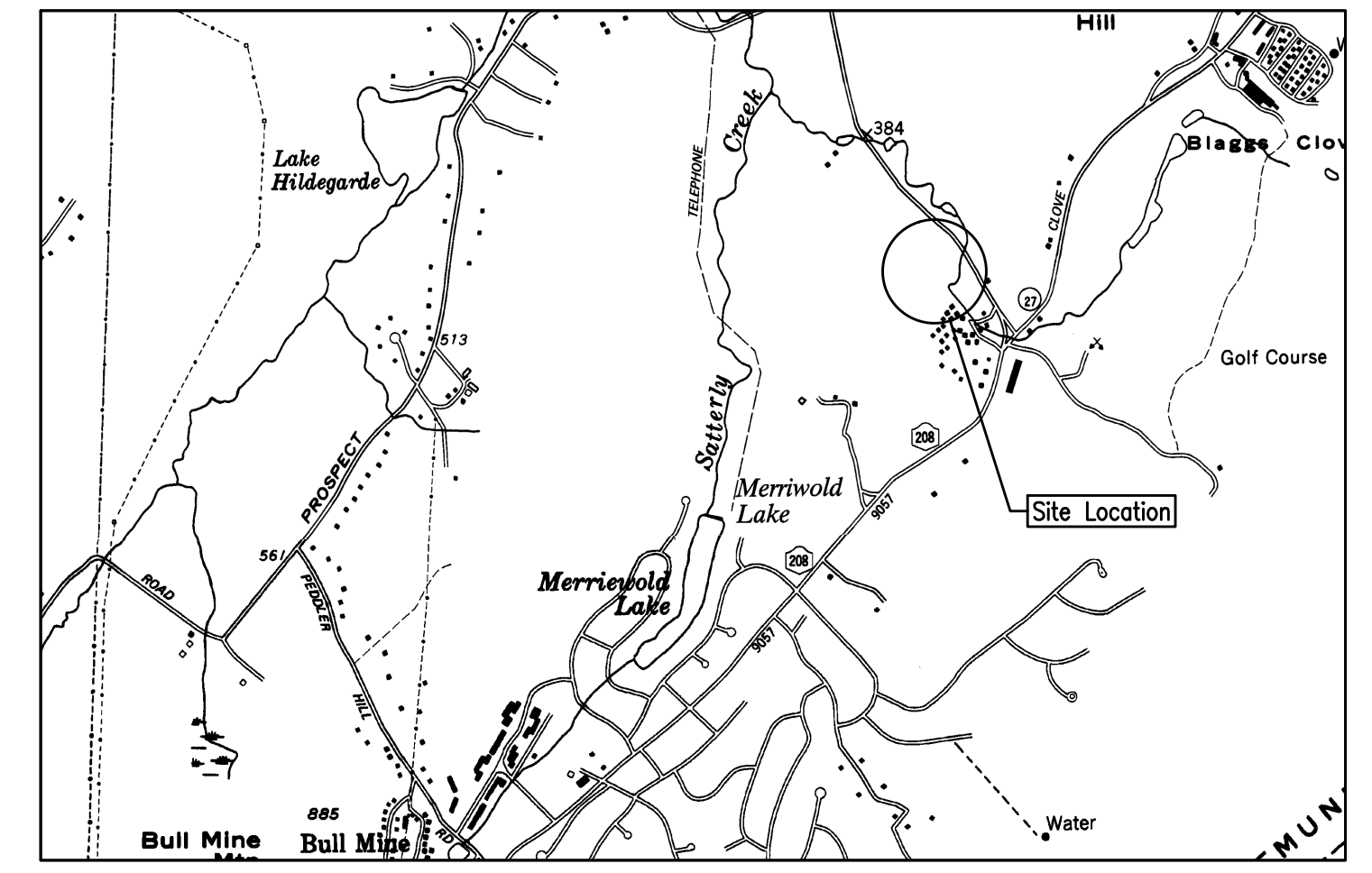

VICINITY MAP
 N.T.S.

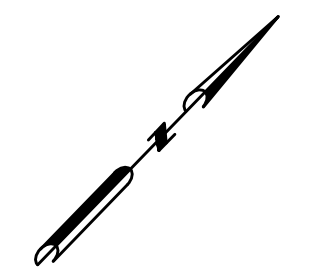

#21519
 EDWARD T. GANNON, P.L.S.
 CHERRY HILL ROAD ~ BLOOMING GROVE, NY 10914
 EGANNONSURVEYING@YAHOO.COM

2 LOT SUBDIVISION
 PREPARED FOR
 1233 NYS ROUTE 208
 VILLAGE OF SOUTH BLOOMING GROVE
 TOWN OF BLOOMING GROVE, COUNTY OF ORANGE, STATE OF NEW YORK
 SECTION 204 BLOCK 1 LOT 1
 SCALE: 1" = 50'
 SURVEY DATE: MARCH 1, 2022
 TOTAL AREA: 12.85 ACRES